

# CERTIFICATE OF LOCATION OF GOVERNMENT CORNER

# 20 MEANDER Corner of Section 21, Township 108 N., Range 40 W., 5<sup>th</sup> P.M.

STATE OF MINNESOTA, County of MURRAY

At the corner location shown on the sketch:

- On \_\_\_\_\_ found a \_\_\_\_\_  
DATE
- left monument as found,  lowered monument,  removed monument (explain)
- On 7-1-85 placed a 1 1/4" x 1 1/4" x 20" PERFORATED STEEL TUBE WITH  
DATE ALUMINUM CAP STAMPED "D.N.R. SURVEY MARKER", UP 0.4'

### SKETCH OF REFERENCE TIES

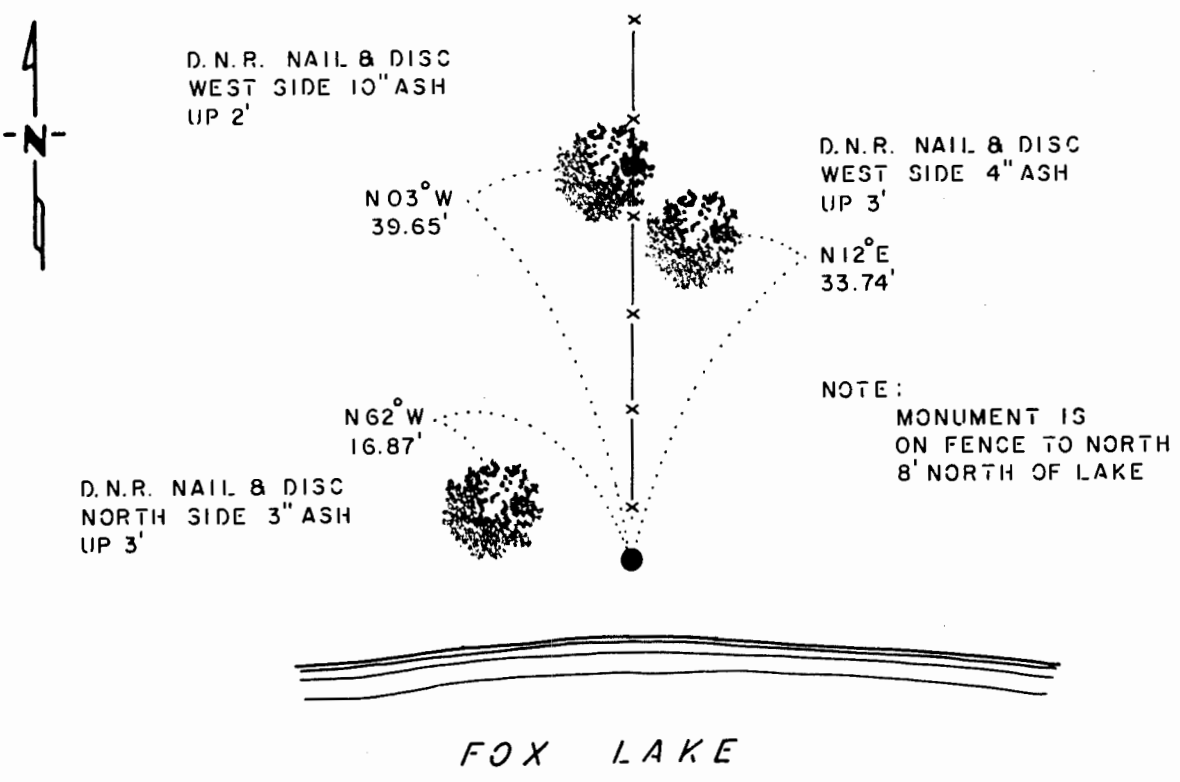

BEARINGS OBSERVED WITH COMPASS

Statement of evidence relative to this corner location is on back of page.

J.B.M. 7-11-85  
G-361

I hereby certify that this document and the data contained herein was prepared by me or under my direct supervision.

Llewellyn R. Pomeroy 7-22-85  
SIGNATURE DATE

- Registration No. 17005
- Land Surveyor,  Professional Engineer
  - County Surveyor,  County Engineer

OFFICE OF THE COUNTY RECORDER **172139**  
County of Murray

I hereby certify that this document was filed in the Co. Recorders office at 10 .M. on the 30<sup>th</sup> day of July A.D., 1985

County Recorder Shirley J. Stone  
By \_\_\_\_\_, Deputy

DOCUMENT NO. 172139

Meander Corner #20 of Section 21, Township 108 North, Range 40 West

This corner was originally established by the U. S. General Land Office survey in 1861. The government notes show corner marked with a wood post set in mound of earth with pits and trench dug around the mound.

In October 1984, the DNR Bureau of Engineering contacted the Murray County Offices of the Recorder and Highway Engineer for corner information.

No resurvey information was obtained on this corner.

In October 1984, the DNR Bureau of Engineering traversed to the area of the corner and located a north-south fence beginning at the top of lake bank. Computed a lost position for this corner using the east quarter corner of Section 21 and the northeast corner of Section 33. This position was found to fall on the southerly extension of the fence line north.

Accept the lost position as the location of the corner.

Traverse information is available from the DNR Bureau of Engineering.

rec15/missu2